

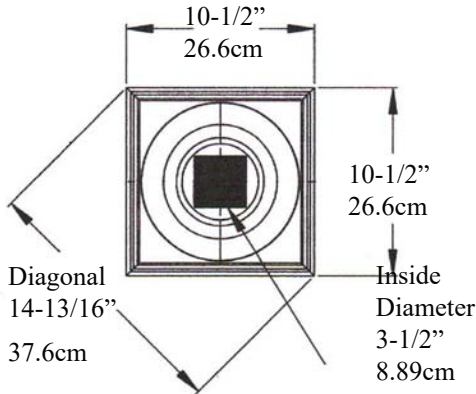

Temple Winds Non-Tapered IPTUS1008SNT-TWAB FRP-PolyComp™

Temple Capital FiberComp™



Cap Height
7-1/2" (19cm)=>

Astragal =>

Top of Shaft
Minimum
Inside Diameter
6-3/4" (17.1cm)

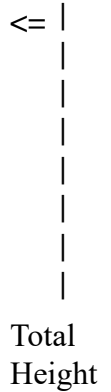

Total Height
127-1/2"
313.85cm

Attic Base EconPolymert™

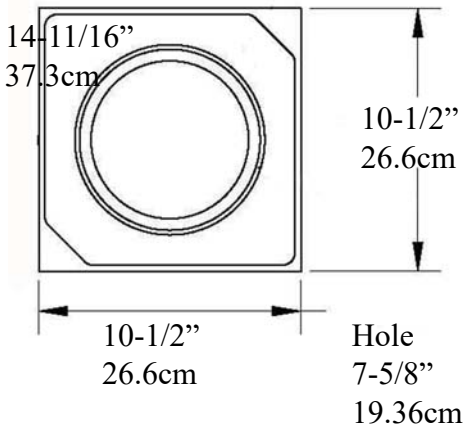

Outside Diameter
7-5/8" (19.36cm)

Bottom of Column
Outside Diameter
7-5/8"
19.36cm

Shaft weight
78 lbs (35.4kg)
Center Loads to
10,000lbs
4.53m tons

Attic Base
4-1/2" (11.43cm) =>

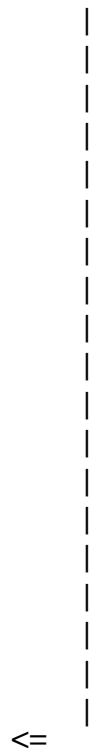

Optional Cuts

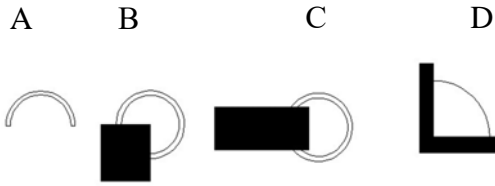

- A= Half column
- B = 3/4 Outside Corner
- C = Wall Cover Engaged
- D = 1/4 Column Inside Corner
- E = Engaged any percentage



* *assembly required, drawing not to scale*

* *For Load Application check with your structural engineer for suitability in your local area*

* All specifications subject to change without notice, Final products & Measurements may vary from this brochure



Imperial Productions®

1-800-399-7585

Imperial Productions & Distribution Inc.

email sales@imperialproductions.com copyright 2016 MRDCI All Rights Reserved

SEP-24



REQUEST FOR COLUMN QUOTE

Download and Auto Fill

Name / Company _____

Contact Name: _____

Phone # _____ Email: _____

Bill To Address

ShipTo Address

ZIP/PC _____

ZIP/PC _____

Product Code _____

- 1) Residential
- 2) Commercial
- 3) Commercial Load Bay

of Columns Whole _____

Fill in _____

Split for Wrap (A) _____

Notes: _____

Split for Engaged (A) _____



Split B _____

Split C _____

Split D _____

Date: _____



Imperial Productions®

1-800-399-7585

Imperial Productions & Distribution Inc.

email sales@imperialproductions.com copyright 2016 MRDCI All Rights Reserved